

ATP1A3 IN DISEASE SYMPOSIUM EVENT GUIDE

Chicago, October 27-28, 2023



FRIDAY – SATURDAY, October 27-28, 2023

Northwestern University, Feinberg School of Medicine
303 E. SUPERIOR ST. CHICAGO, IL 60611



Location

Conference events will be taking place at the Robert H. Lurie Medical Research Center at 303 E Superior St, Chicago, IL 60611.

Feinberg School of Medicine Campus



[Northwestern University Campus Map](#)

Robert H. Lurie Biomedical Research Center

The scientific program will take place in Baldwin Auditorium, secondary sessions and a remote viewing room will be held in the Searle and Gray rooms, meals and the poster session will be held in Ryan Family Atrium.

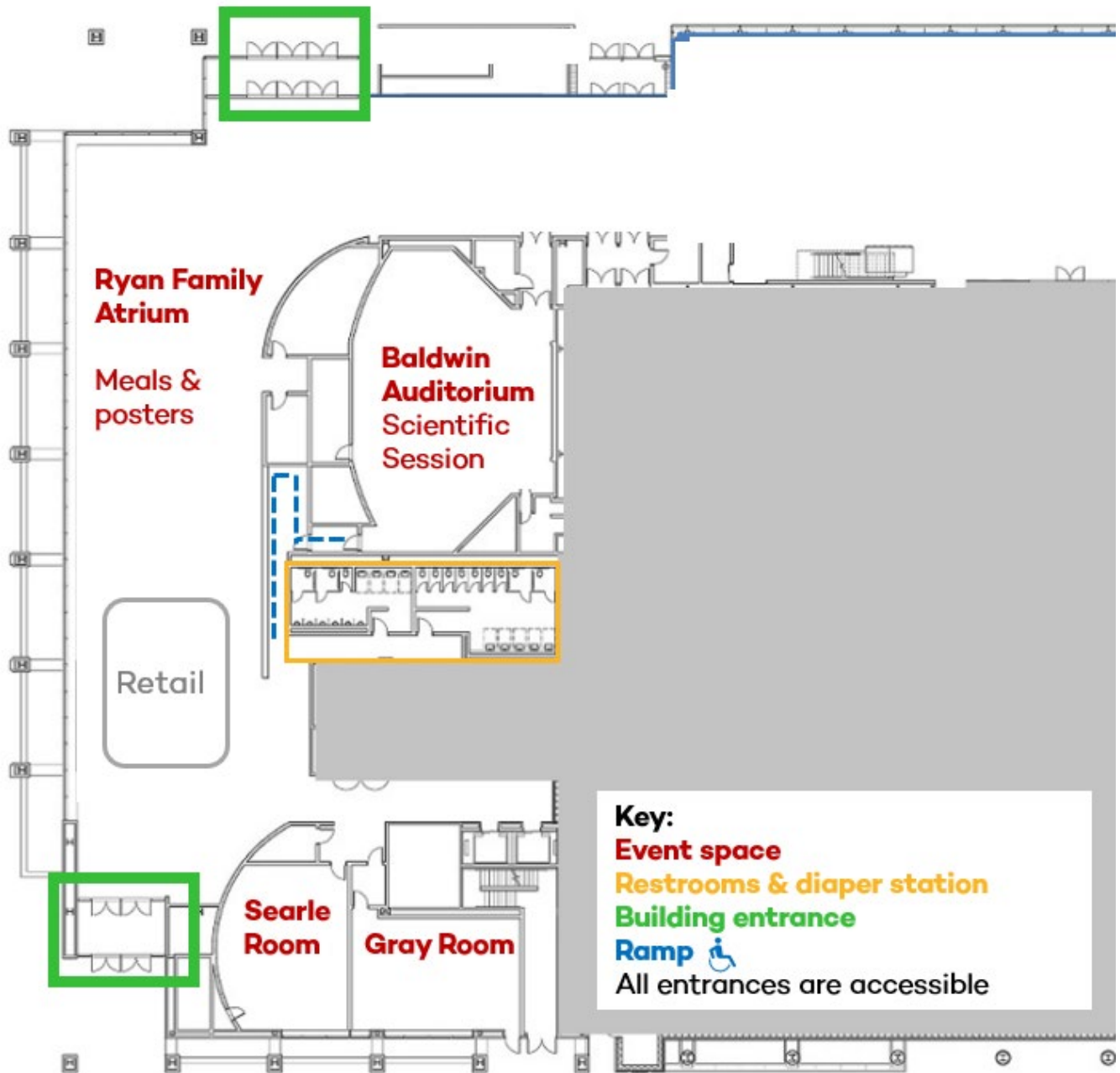

Hotel

The Hyatt Centric Magnificent Mile will be offering conference attendees discounted rooms from October 26th to 29th. Located at 633 N St Clair St, the hotel is a short walk from campus.

To book, call **877-803-7534** and request the **AHC Foundation Room Block**

[View on Google Maps](#)

Transportation

From O'Hare Airport (15 miles)

We recommend using an Uber/Lyft or a taxicab. Fares should run about \$40 unless there is heavy traffic or surge pricing on the former.

Public transport is available starting at the Blue Line El station at O'Hare, the Blue Line has multiple stops downtown. We would recommend taking a rideshare from the Blue Line to your hotel, but there are also plenty of Bus Routes.

From Midway Airport (13 miles)

We recommend using an Uber/Lyft or a taxicab. Fares should run about \$40 unless there is heavy traffic or surge pricing on the former.

Public transport is available starting at the Orange Line El station at Midway. Disembark from the El at the Chicago and Milwaukee stop and take the #146 bus northbound to Michigan and Huron, which is two blocks west of the Hyatt and the Lurie Medical Research Center.

Getting around Chicago

Taxis and Uber/Lyft cars are abundant in downtown and are used routinely. The El and CTA buses are cheaper and used frequently downtown and to access nearby neighborhoods.

Parking

We recommend using parking apps to find parking near our campus. [ParkChirp](#) and [SpotHero](#) offer both hourly and daily options with a combination of self-park, valet, and in/out options. You can download the apps in the Apple or Google Play stores and browse available parking lots around campus.

Meals

Meals will be served outside of Baldwin Auditorium in the Ryan Family Atrium space. During both days of the meeting, we will be offering:

- Continental breakfast from 7:15 to 8:00am
- Boxed lunches (either a Sandwich or Salad with sides)
- Beverages and snacks throughout the day including coffee, tea, and water
- Conference dinner will be taking place Saturday October 28th Location TBA

We have many coffee shops and restaurants within walking distance should you choose to eat off campus, including several on the mezzanine level of Northwestern Memorial Hospital (Subway, Café L'Appetito, Greek Kitchen, Panera Bread, Protein Bar, and Burrito Beach).

All attendees are invited to join us for dinner Saturday October 28th, the time and location will be announced at a later date.

Restaurant Recommendations

Lunch

In addition to the options in NMH, several other restaurants are located in the vicinity of the NU campus and Hyatt. A few that we like include:

- [Beatrix](#) | American café, bakery, wine & cocktail bar, 676 N St Clair St
- [Cafecito](#) | Cuban sandwich and coffee café, 215 E Chestnut
- [LYFE Kitchen](#) | Healthy eats, 270 E Ontario
- [Nando's PERi-PERi](#) | Afro-Caribbean chicken, 227 E Ontario St
- [Ramen San](#) | Ramen noodle shop with Gluten free options, 165 E Huron St
- [Tallboy Taco](#) | Street tacos, 676 N St Clair St

Dinner

There are many great restaurants located within a 20-minute walk from the conference venue, a few recommendations are below.

- [The Capital Grille](#) | Fine Dining and Steakhouse, 633 N St. Clair
- [Woodwind](#) | New American with many vegetarian options, 259 E Erie - 18th floor
- [Indian Garden](#) | Indian and Vegetarian, 247 E Ontario – 2nd floor
- [Le Colonial](#) | Upscale French-Vietnamese fare, 57 E Oak
- [Fig & Olive](#) | Seasonal Mediterranean, 104 E Oak

Accessibility

All the entrances and rooms highlighted on the map are wheelchair accessible. Both Ryan Atrium and the Gray room are flat surfaces, while our auditoriums are built on an incline with small steps and railings. In the Searle room, wheelchairs may be limited to the front row only while Baldwin has the option for the front or back row.

A diaper station will be set up in the closest bathroom (see map), which is ADA compliant. Another station will be available with more privacy, please see our Accessibility Desk to be shown to the private room. You can direct any other accessibility questions or accommodation requests to the email below.

Poster presentations

Poster presentations will take place during the lunch hour. You can set up posters at the start of the meeting and leave them up overnight. We do ask that you keep your poster up for the duration of the meeting, but the amount of time you spend presenting each day is up to you.

Questions?

We are happy to provide more info and recommendations, you can reach out to your event hosts at ATP1A3@northwestern.edu or by calling 312.503.4893